

The Light Source Bar Joist Washer

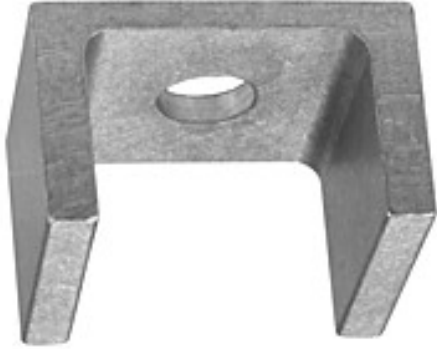

The bar joist washer hooks over the top of bar joists legs up to 1-7/16" wide. The U-shape of the bar joist washer prevents it from slipping off.

**Working Load
Limit** 1,650 lbs.

Order Codes **BJW1/2B** Bar Joist Washer for 1/2" Rod, Black Anodized
 BJW1/2M Bar Joist Washer for 1/2" Rod, Silver
 BJW3/8B Bar Joist Washer for 3/8" Rod, Black Anodized
 BJW3/8M Bar Joist Washer for 3/8" Rod, Silver